



3934 Santa Nella Place, San Diego, CA 92130 USA
Phone/Fax: 858-792-6168 E-mail: tech@skykingproducts.com

1997-onward All Triumph Daytona 955's and Speed Triples Item 090: Adjustable Clutch Lever Installation Instructions

Parts List:

One each: SkykingProducts.com Adjustable Clutch Lever Assembly
Two each: Solderless electrical push terminals

Tools and Materials:

Front and Rear Stand; socket set; combination wrench set; Socket (Allen) head set; Phillips Head and Straight Screwdrivers; grease, wire cutter/stripper/crimper.

Precautions:

A clutch failure can be fatal so if you not certain of any of these steps seek expert help. Use a rear stand as a minimum and if you have a front stand use that as well during installation. Have rags in the area where the work will take place for added protection during the installation process. Verify all mounting hardware is tightened to factory specifications.

Adjustable Clutch Lever installation steps:

1. Remove the seat and disconnect the black negative lead from the battery (Phillips Head Screwdriver (PHS)).
2. Remove the clutch lever (5mm Socket Head (SH)).

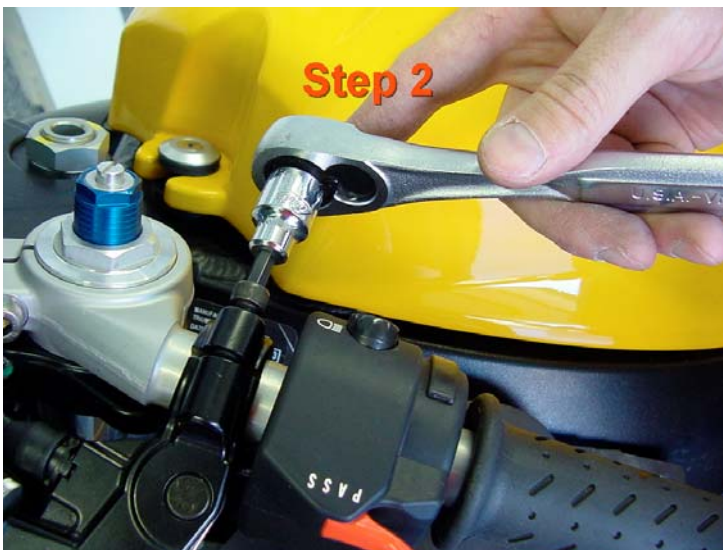

3. Remove clutch cable by aligning the lever adjuster and lock nuts slots.

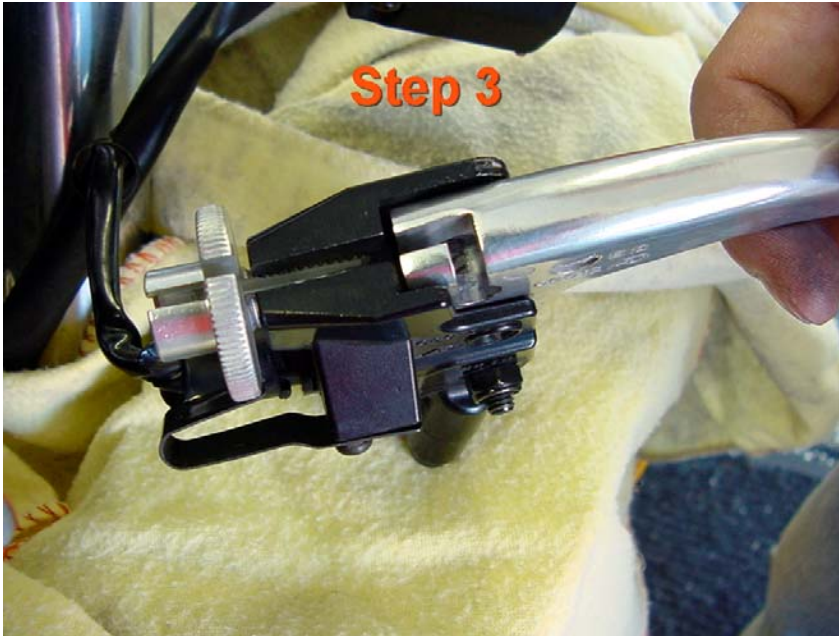

4. Disconnect the wiring to the clutch switch by cutting the wire as close as possible to the clutch lever (Wire Cutter/Stripper (WCSC)).





5. Check the clutch cable for frayed strands and cable ends for damage. Replace if damaged.
6. Now, terminate the wires that we cut in step 5 by crimping the push terminals (WCSC). Install the two solderless push terminals on the end connectors of the switch and leave the center connector un-terminated.

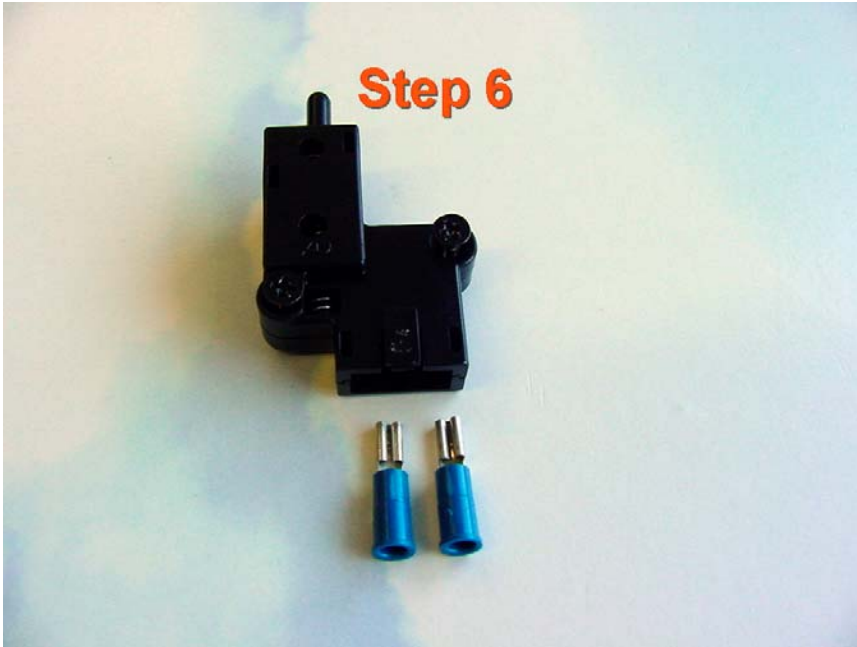

7. Now is a good time to lube the inner cable and both cable ends as well.





8. Attach the inner clutch cable to the Skyking Adjustable Clutch Lever. Note: Rotate Skyking Clutch Lever Dial to setting "5".
9. Install the Skyking Adjustable Clutch Lever on the handlebar/clip-on bar and position lever to back to in place original place then torque two places to 15Nm (5mm SH).



10. Engage the Skyking Adjustable Clutch Lever several times and adjust for 0.4 to 0.8 mm of free play. Tighten the ribbed locking nut once free play adjustment is completed.
11. Connect black negative lead from the battery (Phillips Head Screwdriver (PHS)). Note: This is a great time to apply Petroleum Jelly or Dielectric grease to positive and negative battery terminals.
12. Install seat that you removed in step 1.
13. Prior to proceeding any further make certain you have the motorcycle secured on the front and rear stands and the gear box is in neutral.
14. Move handlebars left to right (lock to lock) and make sure there is no binding.
15. Engage clutch and start engine.
16. Clean up, double check your work and make certain all fasteners are tightened to factory specifications. Take a short test drive and double check your work again.



WARRANTY AND REMEDY:

Skyking hereby warrants that at the time of delivery thereof the parts bought will be free from defects in material and workmanship and will conform to the requirements of the order. Skyking assumes no liability for faulty or improper installation or use. All claims under this warranty must be made in writing to Skyking. Upon receipt of authorization from Skyking, the parts claimed to defective or non-conforming must be returned freight prepaid, to Skyking. Skyking will repair, or its option, replace any defective or non-conforming parts and will return the repaired part or its replacement without charge. The failure to give Skyking written notice of any claim hereunder within the warranty period shall constitute a waiver of all claims hereunder. The foregoing states Skyking's remedy for any breach of warranty and for any claim whether sounding in contract or tort, based upon any defect in Skyking's parts. This warranty does not extend to the parts that have been altered or repaired nor does it extend to parts that has been subjected to misuse, neglect, accident, or improper installation. Skyking shall not, in any event, be liable for any incidental or consequential damages nor for any other damages more than the purchase price for the part. By accepting and or installing this item you fully agree to the terms and conditions of the warranty. THE FOREGOING WARRANTIES ARE EXCLUSIVE AND ARE IN LIEU OF ALL OTHER WARRANTIES, WRITTEN, ORAL, OR IMPLIED, INCLUDING WARRANTY OF MERCHANTABILITY OR FITNESS FOR A PARTICULAR PURPOSE.